

Hinged balcony doors

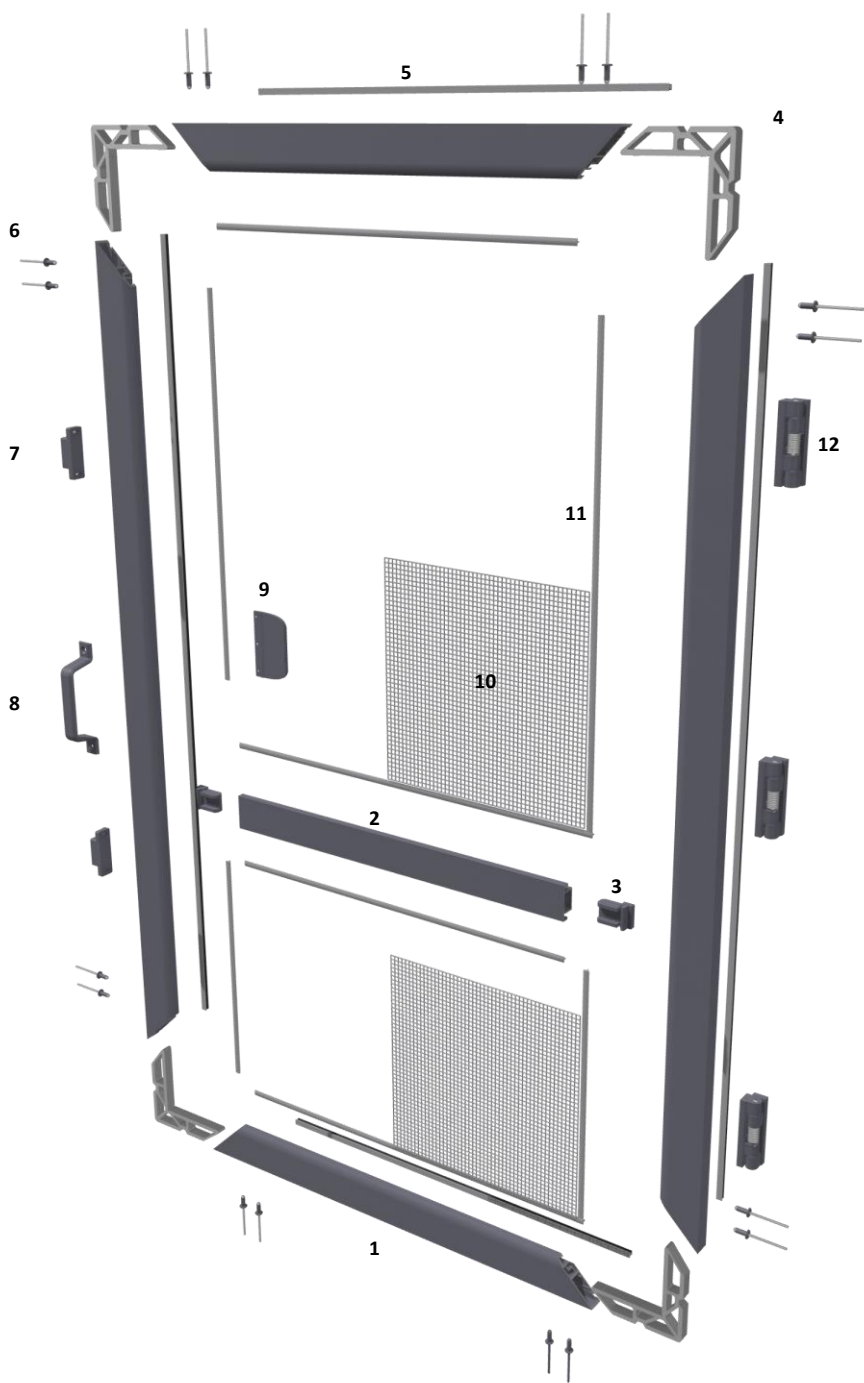

No.	Element	Element code
1	Main profile	M-205
2	Cross profile	M-210
3	Connector for cross profile	M-250
4	Corner	M-230
5	Seal brush	M-290
6	Rivets	M-295
7	External magnetic lock	M-280
8	External door handle	M-260
9	Interior door handle	M-271
10	Mesh	S-180
11	T-spline for mesh	S-160
12	Hinge with spring	M-245

* The accessories shown (handles, hinges, magnets, seals, rivets, connectors) are for illustrative purposes only, and their scale relative to the model has been deliberately exaggerated in order to show the construction details.

Correct placement of hinges and magnetic locks

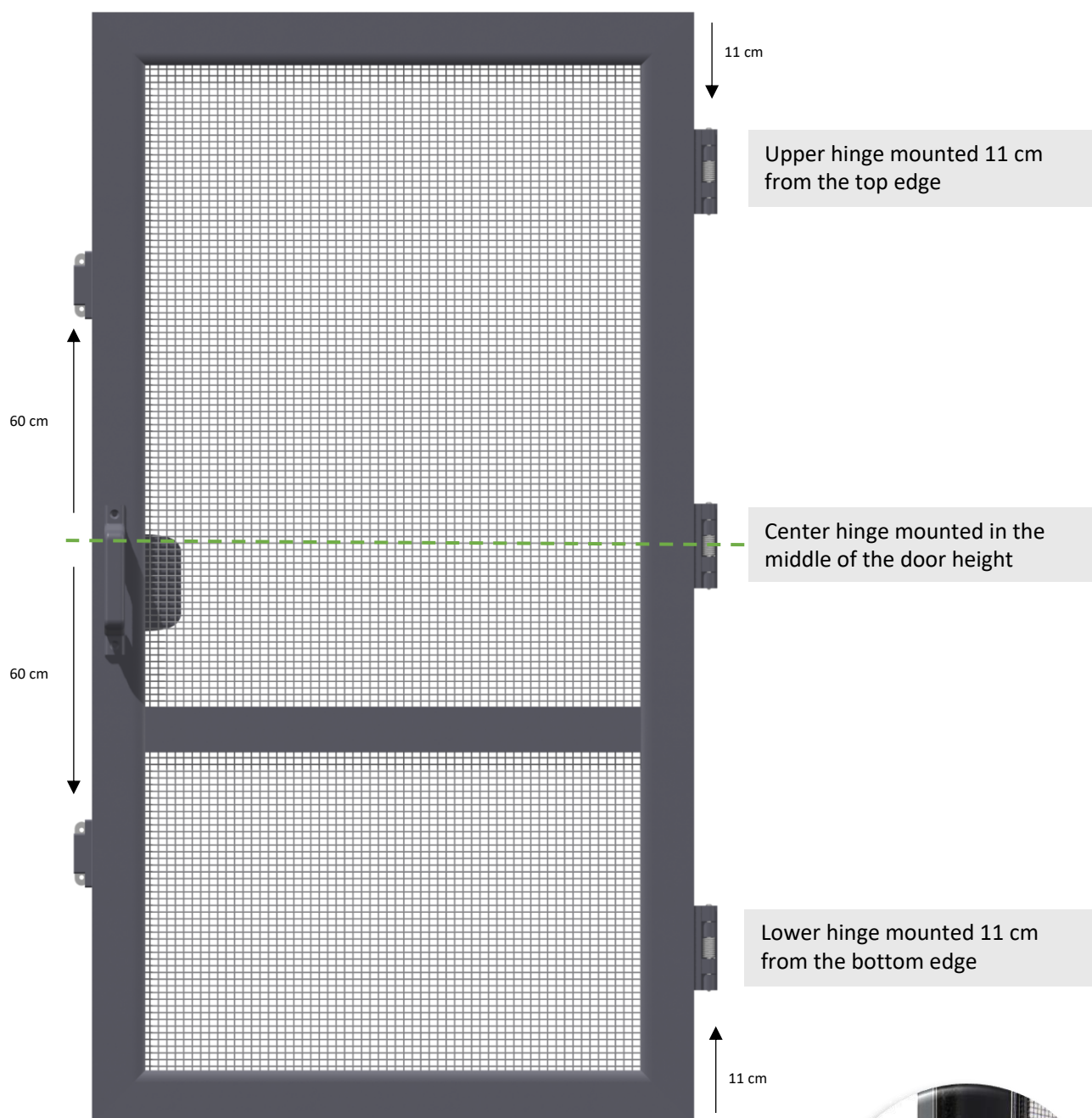

- Magnetic locks are mounted at a distance of 60 cm from the middle of the height for doors up to 230 cm.
- For doors taller than 230 cm, the spacing between magnets is 65 cm from the middle of the height.
- For doors with an M-285 mortise magnetic lock (see illustration), we use three magnets. The third magnet is mounted in the middle of the door height.
- The spacing for doors with mortise magnetic lock is the same as for doors with external magnetic locks.

